

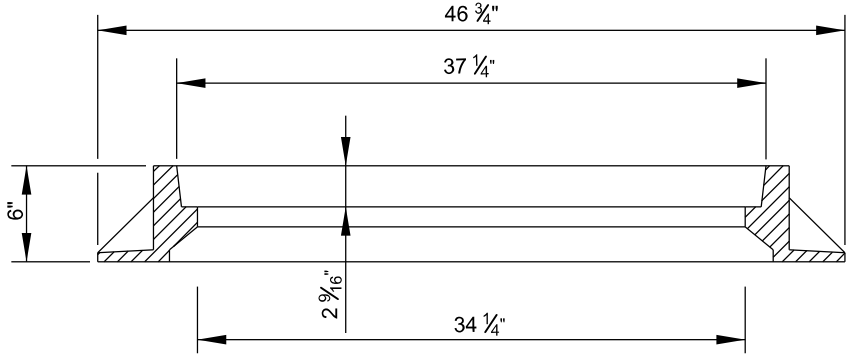

PLAN OF CASTING FRAME



SECTION A-A

- NOTES:
1. MANHOLE COVER TO BE TRAFFIC RATED AASHTO M306.
 2. MANHOLE SHALL BE GRAY IRON ASTM A48 - CLASS 30B MIN.
 3. PROVIDE CHUCKING AREA AND HANDLING HOLES AS PER THE MANUFACTURERS DETAIL.
 4. PROVIDE 37 1/4" DIAMETER FOR FRAMES PAIRED WITH STANDARD 37" DOT CONDUIT MANHOLE COVER, BC 825.14-01.

	APPROVED : <i>Ola Olamide</i> CHIEF, CONDUIT DIVISION	CITY OF BALTIMORE DEPARTMENT OF TRANSPORTATION CONDUIT DIVISION	ISSUED 08/2024	REVISED 	REVISED 	
	<i>Husein Raiz</i> DIRECTOR, DEPARTMENT OF TRANSPORTATION	MANHOLE - CONDUIT STANDARD 37" FRAME	STANDARD NO. BC 825.14-02			SCALE : NONE
					SHEET 1 OF 1	